

OVERALL SITE PLAN- ROSALIA TRAILHEAD

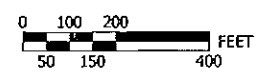

CAD NO.		
	INT.	DATE
	APP.	
	REV.	
	NO.	

ACTION	BY	DATE
DESIGNED	JV	10/31/13
DRAWN	JPS	10/31/13
CHECKED (FIELD)		
CHECKED (HDQTS.)		

PROJECT ENGINEER

WASHINGTON
STATE
PARKS
AND
RECREATION
COMMISSION



IRON HORSE STATE PARK
MASTER PLAN
AMENDMENT

IRON HORSE PALOUSE -
MALDEN TO IDAHO
BORDER

TEKOA TRAILHEAD
CONCEPTUAL SITE PLAN

1-22-2014

SHEET 1 OF 4

ROSALIA TRAILHEAD FACILITY INVENTORY:
 (PARALLEL PARKING AREA 1200 LF X 15' WIDTH)
 12 PARALLEL TRAILER PARKING SPACES AT 60' L (720 LF)
 16 PARALLEL SINGLE VEHICLE PARKING SPACES AT 30' L (480' LF)
 1 DOUBLE VAULT TOILET
 2 16'X24' PICNIC SHELTERS
 1 INFORMATIONAL KIOSK
 HORSE HITCHES
 SIGNAGE (INTERPRETIVE, INFORMATIONAL, DIRECTIONAL)

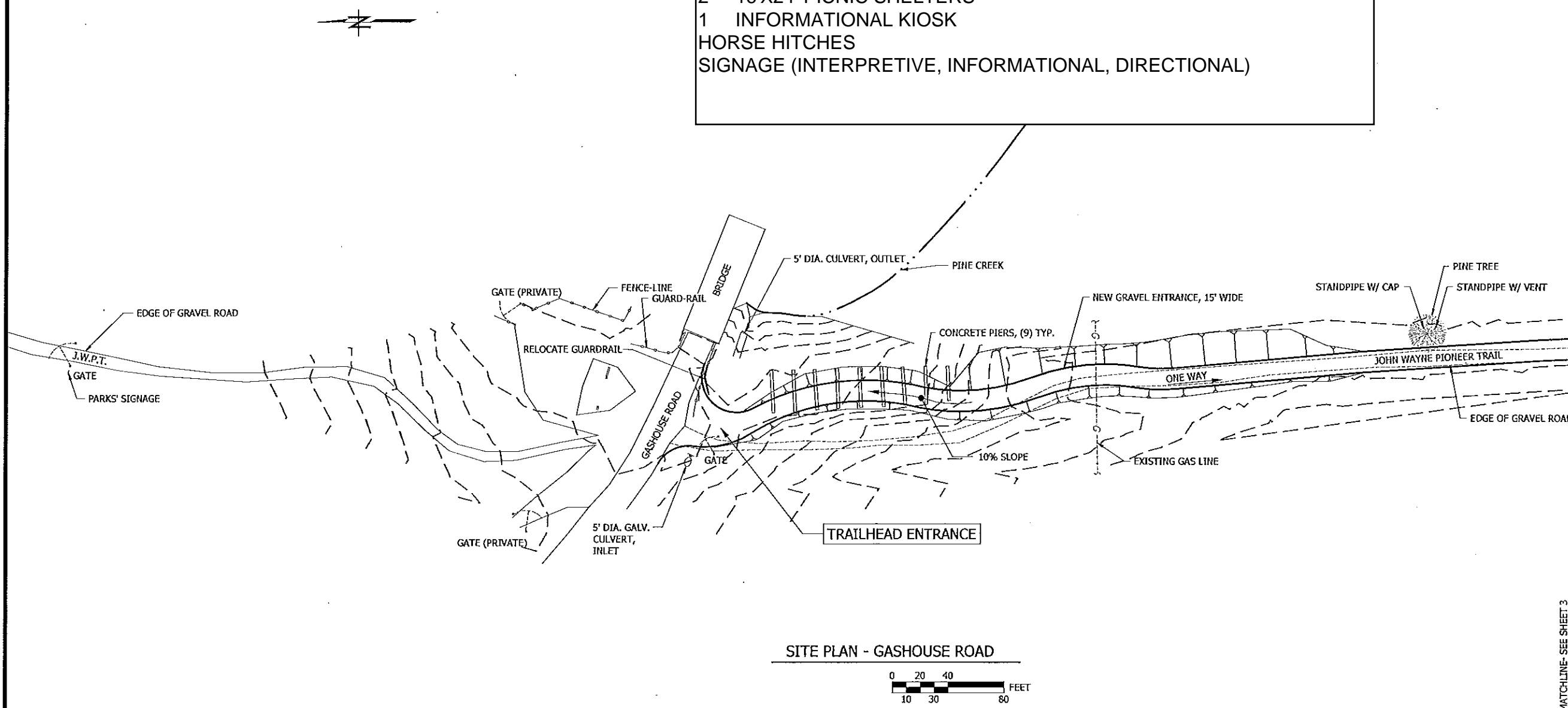

SITE PLAN - GASHOUSE ROAD

0 20 40 FEET
 10 30 80

CAD NO.		DATE
		APP.
		REVISONS
		NO.

ACTION	BY	DATE
DESIGNED	JV	10/31/13
DRAWN	JPS	10/31/13
CHECKED (FIELD)		
CHECKED (HDQTS.)		

PROJECT ENGINEER

WASHINGTON STATE PARKS AND RECREATION COMMISSION



IRON HORSE STATE PARK MASTER PLAN AMENDMENT

IRON HORSE PALOUSE - MALDEN TO IDAHO BORDER

ROSALIA TRAILHEAD - GASHOUSE ROAD CONCEPTUAL SITE PLAN

1-22-2014

MATCHLINE - SEE SHEET 3

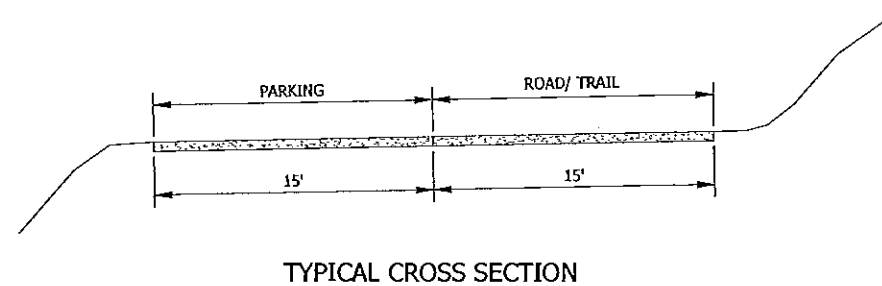
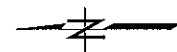

MATCHLINE - SEE SHEET 2

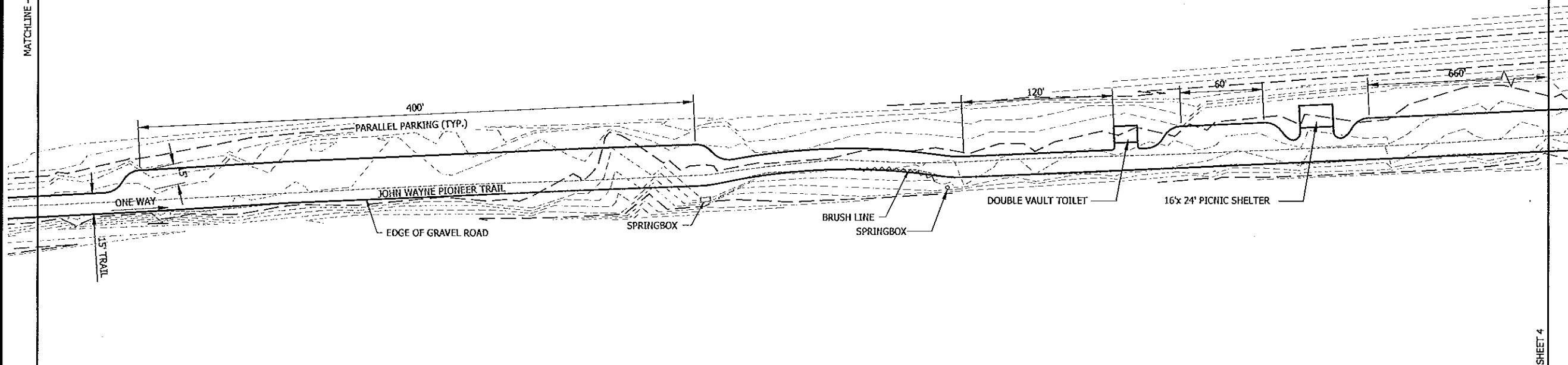

SITE PLAN - ROSALIA TRAILHEAD MID

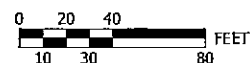

MATCHLINE - SEE SHEET 4

CAD NO.	
	DATE
	APP.
	INT.
	REVISONS
	NO.

ACTION	BY	DATE
DESIGNED	JV	10/31/13
DRAWN	JPS	10/31/13
CHECKED (FIELD)		
CHECKED (HDQTS.)		

PROJECT ENGINEER

WASHINGTON
STATE
PARKS
AND
RECREATION
COMMISSION



IRON HORSE STATE PARK
MASTER PLAN
AMENDMENT

IRON HORSE PALOUSE -
MALDEN TO IDAHO
BORDER

ROSALIA TRAILHEAD -
MIDDLE SECTION
CONCEPTUAL SITE PLAN

1-22-2014

SHEET 3 OF 4

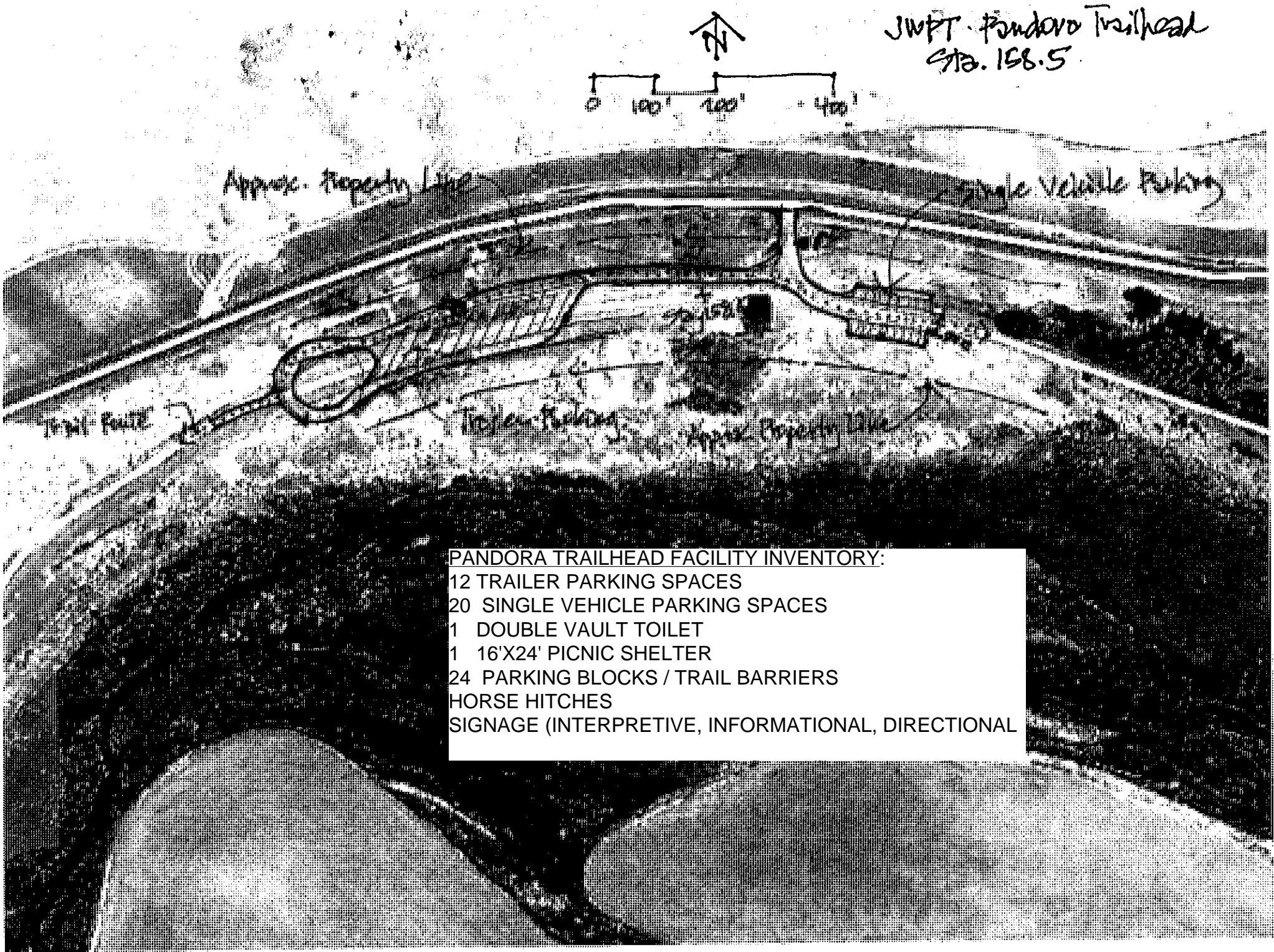

PANDORA TRAILHEAD FACILITY INVENTORY:
 12 TRAILER PARKING SPACES
 20 SINGLE VEHICLE PARKING SPACES
 1 DOUBLE VAULT TOILET
 1 16'X24' PICNIC SHELTER
 24 PARKING BLOCKS / TRAIL BARRIERS
 HORSE HITCHES
 SIGNAGE (INTERPRETIVE, INFORMATIONAL, DIRECTIONAL)

REVISIONS
NO.
INT.
APP.
DATE

ACTION	BY	DATE
DESIGNED		
DRAWN	GHC	12-28-2011
CHECKED (FIELD)		
CHECKED (HQTS.)		

PROJECT ENGINEER

WASHINGTON
 STATE
 PARKS
 AND
 RECREATION
 COMMISSION



IRON HORSE STATE PARK
 MASTER PLAN
 AMENDMENT

IRON HORSE PALOUSE -
 MALDEN TO IDAHO
 BORDER

PANDORA TRAILHEAD
 CONCEPTUAL SITE PLAN

1-22-2014

- TEKOA TRAILHEAD FACILITY INVENTORY**
 10 TRAILER PARKING SPACES
 20 SINGLE VEHICLE PARKING SPACES
 2 DOUBLE VAULT TOILETS
 2 16'X24' PICNIC SHELTERS
 HORSE HITCHES
 SIGNAGE (INTERPRETIVE, INFORMATIONAL, DIRECTIONAL)

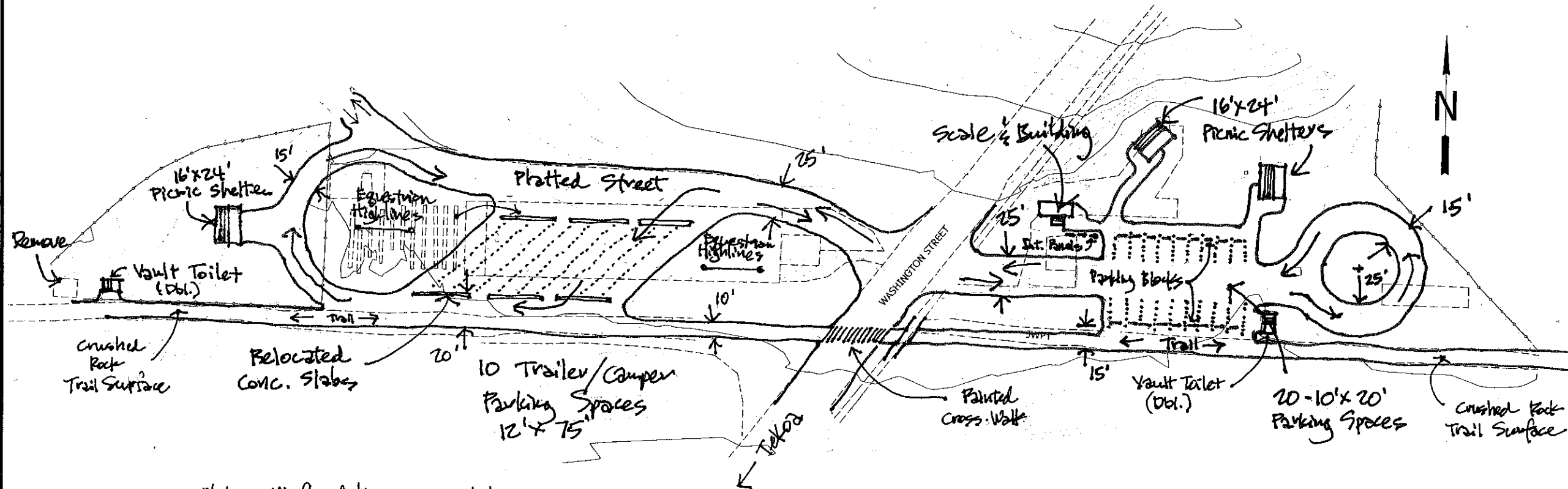

Note: All foundations, conc. slabs and structures, except the Scale House, are to be removed.

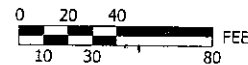

NO.	REVISIONS	INT.	APP.	DATE

ACTION	BY	DATE
DESIGNED		
DRAWN		
CHECKED (FIELD)		
CHECKED (HDQTS.)		

PROJECT ENGINEER

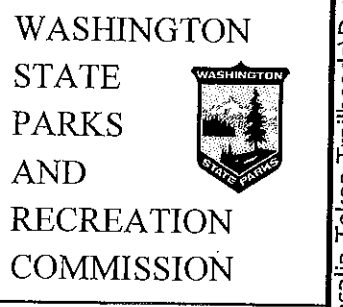

IRON HORSE STATE PARK
 MASTER PLAN
 AMENDMENT

IRON HORSE PALOUSE -
 MALDEN TO IDAHO
 BORDER

TEKOA TRAILHEAD
 CONCEPTUAL SITE PLAN

1-22-2014

SHEET 1 OF 1

M:\Engineering\John Wayne Pioneer Trail\Malden-Rosalie-Tekoa Trailheads\Drawings\tekoa.dwg, 08/14/2012 9:40:15 AM