

LEGEND

- THE HIGH SPOT
- THE PLATEAU
- STEEP ESCARPMENTS
- FORESTED TERRACE
- WETLAND
- RIVER FLOODPLAIN
- WATERWAY HIGH IMPACT BUFFER
- STEEP SLOPE BUFFER (SLOPES AND BUFFERS OUTSIDE PARK BOUNDARY ARE ASSUMED)
- WASHED OUT BRIDGE
- BRIDGE
- ADJACENT TRAIL
- TRIBUTARY
- RIVER/ MAJOR WATERWAY
- PROPERTY LINE



NATURAL RESOURCES SITE ANALYSIS
MASTER PLAN FOR
NISQUALLY MASHEL STATE PARK

Data derived from: Pierce County, Thurston County, Lewis County.
 Critical Areas: Critical area boundaries and buffers depicted on this map are approximate. They have not been formally delineated or surveyed and are intended for planning purposes only. Additional site-specific evaluation may be needed to confirm/verify information shown on this map.
 Buffers: Pierce County Critical Area buffers are from Section 18E of Pierce County Code. Thurston County Critical Area buffers are from Chapter 17 of Thurston County Code.

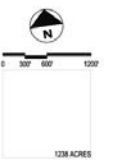

MARCH 2008

1238 ACRES